

roto slide seal R03-P

seal spec

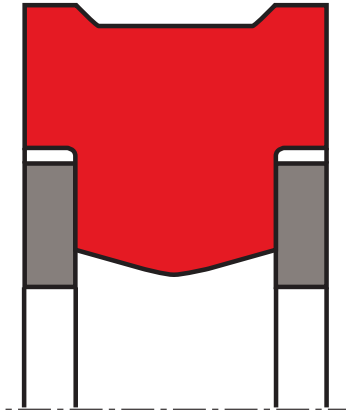

description

rotary seal with integrated backup rings for pivoting motion in hydraulic systems. interference fit on outside diameter maintains stable fit in the housing, backup rings permit larger extrusion gap / higher pressure. mainly used for rotary pivots on excavators, grabs.

application



not bolded symbols; please consult our technical for application limitations

category of profile

machined only.

double acting rotary shaft seal

operating parameters & material

diameter range: up to 600 mm

material		temperature	max. surface speed	max. pressure ¹
sealing element	back-up ring			
s-mart PU	s-mart POM / s-mart PA ²	-30 °C ... +100 °C	0,2 m/s	400 bar (5800 psi)
s-mart HPU	s-mart POM / s-mart PA ²	-20 °C ... +100 °C	0,2 m/s	400 bar (5800 psi)
s-mart SPU	s-mart POM / s-mart PA ²	-20 °C ... +100 °C	0,3 m/s	400 bar (5800 psi)
s-mart LTPU	s-mart POM / s-mart PA ²	-40 °C ... +100 °C	0,2 m/s	400 bar (5800 psi)
s-mart GPU	s-mart POM / s-mart PA ²	-30 °C ... +100 °C	0,2 m/s	400 bar (5800 psi)

the stated operation conditions represent general indications. it is recommended not to use all maximum values simultaneously. surface speed limits apply only to the presence of adequate lubrication film.

¹ pressure ratings are dependent on the size of the extrusion gap.

² POM up to ø260 mm, PA above ø260 mm

surface quality

surface roughness	Rtmax (µm)	Ra (µm)
sliding surface	≤3	≤0,3
bottom of groove	≤10	≤1,8
groove face	≤16	≤3

tolerance recommendation

seal housing tolerances	
Ød	f7
ØD	H8



seal & housing recommendations

please note that we are able to produce those profiles to your specific need or any non standard housing. for detail measurements, please see seal-mart catalog...

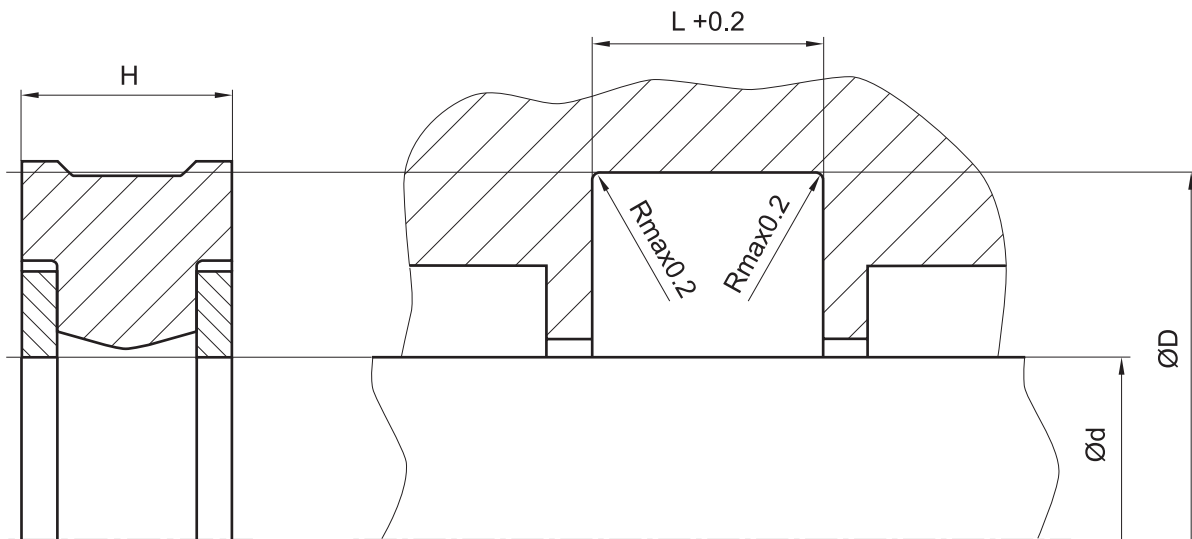

don't hesitate to contact our technical department for further information or for special requirements (temperature, speed etc.), so that suitable materials and/or designs can be recommended.